

NOTES:

1. CLEAN SURFACE WITH ISOPROPYL ALCOHOL & LET DRY BEFORE APPLICATION OF KEYPADS

REVISION HISTORY

REV	DATE	DESCRIPTION	ECO	BY
A	08-03-11	PRODUCTION RELEASE	13484	JRT

ITEM NO.	PART NUMBER	DESCRIPTION	QTY.
1	020-7367	HOUSING, CC, E-BCS, G2	1
2	050-2203	KEYPAD, BCS, CC-G2	1
3	050-2221	LABEL, CC, TR, STARTRAC	1

DOCUMENT STATUS:

NOTICE OF PROPRIETARY INFORMATION

THIS DOCUMENT SHALL NOT BE REPRODUCED NOR SHALL THE INFORMATION CONTAINED HEREIN BE USED BY OR DISCLOSED TO OTHER EXCEPT AS EXPRESSLY AUTHORIZED BY CORE INDUSTRIES, INC., D.B.A. STAR TRAC.

MATERIAL
SEE BOM

UNLESS OTHERWISE SPECIFIED DIMENSIONS ARE IN INCHES. TOLERANCES ARE:
 DECIMALS ANGLES
 X. = ±.13
 X.X = ±.05
 X.XX = ±.03
 X.XXX = ±.010

CORE INDUSTRIES, INC. DBA



14410 Myford Road
Irvine CA 92606

STARTRAC PART NO

718-5303

REV

A

THIRD ANGLE PROJECTION

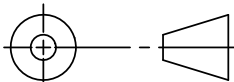

FINISH
N/A

DRAWN	JRT	03/06/11
CHECKED		
APPROVED		

TITLE
ASSY, CC, E-BTS, BASIC, G2 KEYPAD

VENDOR: N/A P/N: N/A

U.O.M. INCH

SCALE: 1:2 SHEET 1 OF 1 SHEET SIZE: A